

Schoolgate Drive Morden, SM4 5DJ

£350,000



A fantastic two double bedroom modern apartment in excellent condition throughout. On the ever popular Willows Development, that is close by to Morden Town Centre and Northern Line Underground Station. The property also comes with its own allocated underground parking space. Being sold with no onward chain, this would be the ideal purchase for a first time buyer or rental investors.

SCHOOLGATE DRIVE, SM4

Approx. Gross Internal Floor Area
570 Sq. ft/53.02 Sq. m

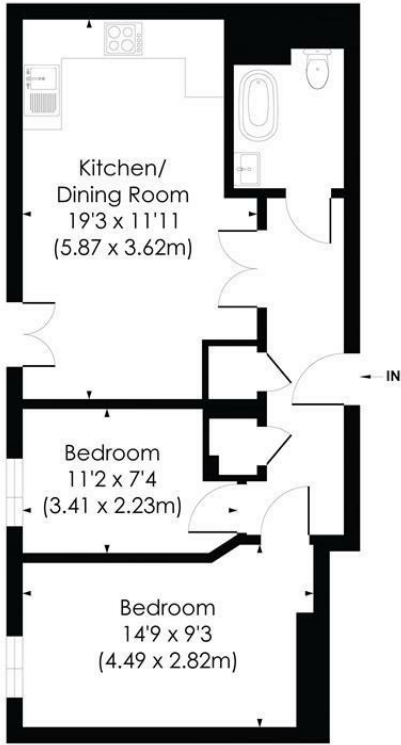

FIRST FLOOR

© Pixangle Property Marketing Ltd. info@pixangle.com Tel: 0208 870 2118
 This floor plan has been prepared for the purpose of illustration only in accordance with the latest RICS code of measuring practice and is not to scale. All measurements and areas are approximate and whilst every effort has been made to ensure the accuracy of the plan contained here, no responsibility is taken for any error, omission or misstatement.



- Two Double Bedrooms
- Popular Willows Development
- Open Plan Kitchen/Reception
- Off Street Parking
- No Onward chain
- EPC - C
- Maintenance £897.02 6 Months



Energy Efficiency Rating		Current	Potential
Very energy efficient - lower running costs			
(92 plus)	A		
(81-91)	B		
(69-80)	C		
(55-68)	D		
(39-54)	E		
(21-38)	F		
(1-20)	G		
Not energy efficient - higher running costs			
England & Wales		78	83
		EU Directive 2002/91/EC	

For Free Mortgage Quote and Best Mortgage Rates, call Ellisons Mortgage Advisor on 0208 543 1166



Although these particulars are believed to be correct, their accuracy is not guaranteed and they do not form part of any contract.

Celebrating 30 years of successful Sales and Lettings in Merton

